











PRODUCT CATALOG



www.callistolocks.in

What Devices Do You Need For Management Your Hotels?

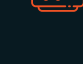
-  Computer
-  Software
-  Card
-  Card Encoder
-  Door Lock
-  Energy Saving Switch
-  Data Collector
-  Elevator Control
-  Digital Safe Box

Callisto Hotel Locks – Where Security Meets Sophistication

Callisto delivers a smart, secure, and stylish locking solution designed for modern hospitality spaces. With features like remote access, fingerprint authentication, and automatic locking, Callisto ensures convenience for guests and control for management—all without compromising aesthetics.

Whether it’s a boutique hotel or a large resort, Callisto integrates effortlessly into any environment, offering elevated security and an enhanced guest experience.

Highlights

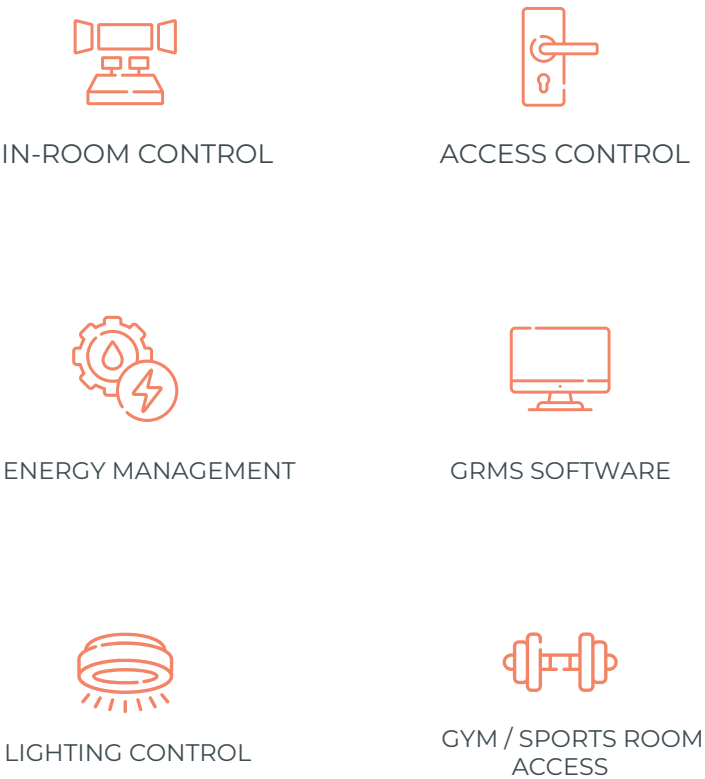

Key Cards Types and Functions

Card Type	Function	Operater
Authorization card	Used to set, clear, and update the door lock password	System Administrator
MasterCard	Used to open all locks	General Manager, Customer Service Manager
Building Card	Used to unlock all the locks on the corresponding building	Customer Service Manager
Floor Card	Used to open all door tocks on the corresponding floor	Floor Attendant
Clean Card	used to open all door locks in a specified area	Cleaner
Emergency Card	Used to open all locks and keep them normally open	General Manager
Guest Card	Used to open the door lock of the specified room	Patron
Terminate Card	Used to terminate the use of the guest card For closing door lock	Floor Service Staff
Lock out Card	For closing door lock	Customer Service Manager
Room No. Setting Card	Set door lock parameters (building number, floor number, room number)	Hotel Maintenance
Foreman Card	Used to open all door locks on the corresponding floor	Duty Manager
Passage Card	Set and deactivate the normally on function Used to check the lock clock	System Administrator
Clock Card	Used to check the lock clock	Hotel Maintenance
Alarm Card	Set and clear the alarm function of door lock false close and open door	Hotel Maintenance
No Disturb Card	Set and clear the anti-lock do not disturb function	Hotel Maintenance
Check-out card	For early termination of guest card use	Duty Manager

Ceto

Stock Generally Available



Colors Available:



Silver

Door Thickness:

38-55mm

Mortise Measurement

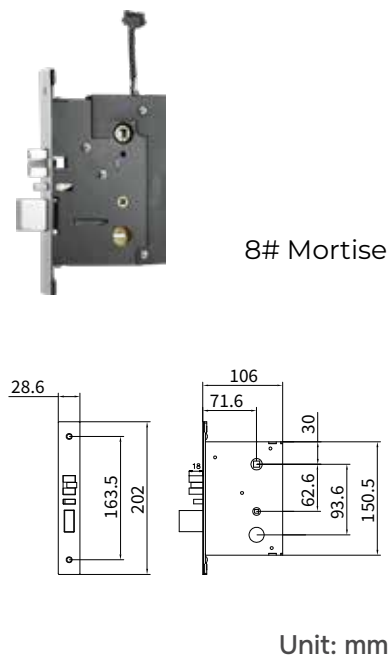

Panel Measurement

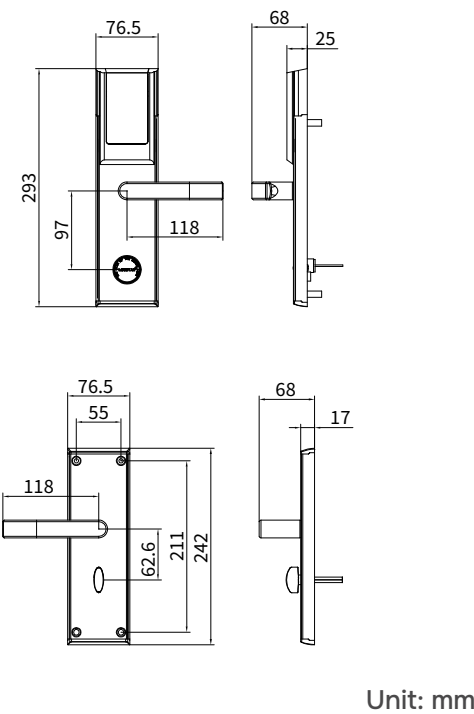

→ Technical Parameter

Lock type	MF card Hotel lock
Unlock way	Mifare S50 card (13.56MHZ) + Mechanical key
Material	Stainless steel both panels+ stainless steel mortise latch+ Alloy Key
Power Supply	4xAA Alkaline battery
Battery life	Around 10000 times (More than one year)
Mortise life	Around 200,000 times
Static Current	<40uA
Door thickness	38-60mm
Working Temp.	-20-55 C
Unlock Record	Record 800pcs recent unlock message
Low Voltage Alarm	5.0V+(0.2V) (lock will remind you to change battery, that time can support atleast 100 times unlocking.)
Working Humidity	16%RH-93%RH
Dynamic Current	≤150mA

Ceto is an hotel door lock designed for easy use and secure access. It supports card and key unlocking, along with PMS integration and energy saver compatibility.This RFID lock is made from stainless steel, it features safety mortise, card loss reporting, and passage mode.Built for long-term durability, it stores up to 800 unlock records and runs on 4 AA batteries.

Apollo

Stock Generally Available



Colors Available:



Silver

Door Thickness:

38-55mm

Mortise Measurement



8# Mortise

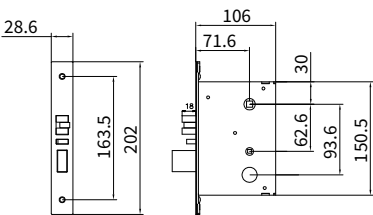

Unit: mm

Panel Measurement

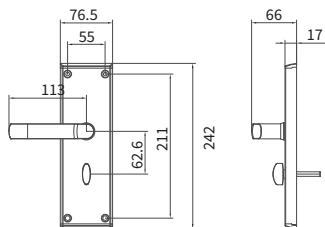
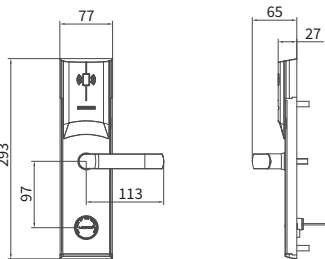

Unit: mm

→ Technical Parameter

Lock type	MF card Hotel lock
Unlock way	Mifare S50 card (13.56MHZ) + Mechanical key
Material	Stainless steel both panels+ stainless steel mortise latch+ Alloy Key
Power Supply	4xAA Alkaline battery
Battery life	Around 10000 times (More than one year)
Mortise life	Around 200,000 times
Static Current	<40uA
Door thickness	38-60mm
Working Temp.	-20-55 C
Unlock Record	Record 800pcs recent unlock message
Low Voltage Alarm	5.0V+(0.2V) (lock will remind you to change battery, that time can support atleast 100 times unlocking.)
Working Humidity	16%RH-93%RH
Dynamic Current	≤150mA

Apollo is an efficient hotel lock designed for efficient access and easy management.It uses Mifare S50 cards and supports both card and key unlocking. Built with superior steel, it includes features like card loss reporting and passage mode. Along with RFID lock it's compatible with major PMS systems for streamlined hotel operations.

Mars

Stock Generally Available



Colors Available:



Silver

Door Thickness:

38-55mm

Mortise Measurement

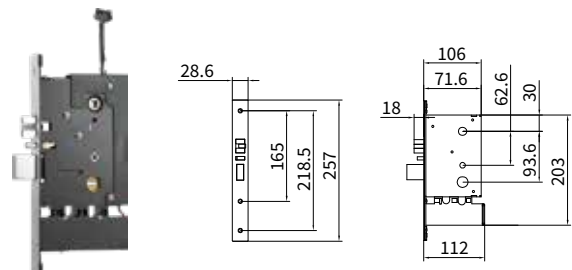

8# Mortise

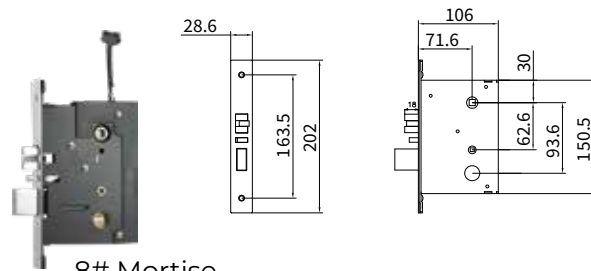

8# Mortise

Unit: mm

Panel Measurement

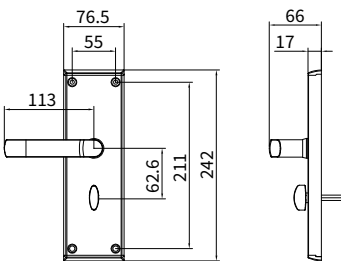
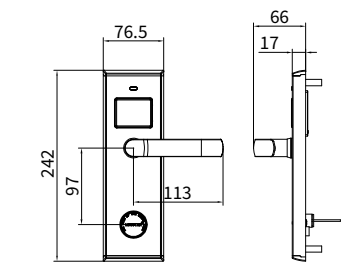

Unit: mm

→ Technical Parameter

Lock type	MF card Hotel lock
Unlock way	Mifare S50 card (13.56MHZ) + Mechanical key
Material	Stainless steel both panels+ stainless steel mortise latch+ Alloy Key
Power Supply	4xAA Alkaline battery
Battery life	Around 10000 times (More than one year)
Mortise life	Around 200,000 times
Static Current	<40uA
Door thickness	38-60mm
Working Temp.	-20-55 C
Unlock Record	Record 800pcs recent unlock message
Low Voltage Alarm	5.0V+(0.2V) (lock will remind you to change battery, that time can support atleast 100 times unlocking.)
Working Humidity	16%RH-93%RH
Dynamic Current	≤150mA

Mars offers secure access with durable steel panels and mortise latch.It uses RFID technology , records up to 800 unlock events and supports energy-saving features. Designed for hotels needing reliable performance and simple card-based access. PMS-compatible and easy to manage for staff and maintenance teams.

Leo

Stock Generally Available



Colors Available:



Silver

Door Thickness:

38-55mm

Mortise Measurement



8# Mortise

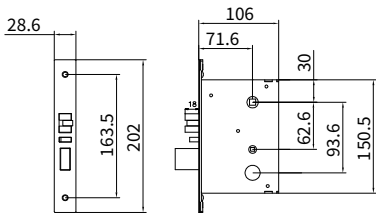

Unit: mm

Panel Measurement

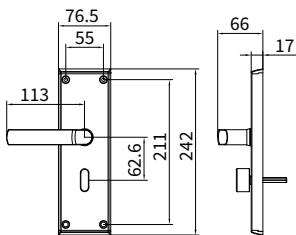
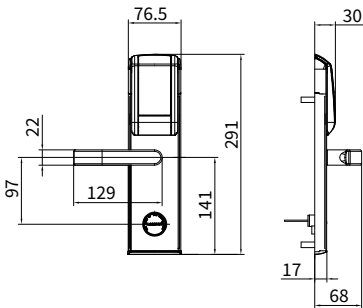

Unit: mm

→ Technical Parameter

Lock type	MF card Hotel lock
Unlock way	Mifare S50 card (13.56MHZ) + Mechanical key
Material	Stainless steel both panels+ stainless steel mortise latch+ Alloy Key
Power Supply	4xAA Alkaline battery
Battery life	Around 10000 times (More than one year)
Mortise life	Around 200,000 times
Static Current	<40uA
Door thickness	38-60mm
Working Temp.	-20-55 C
Unlock Record	Record 800pcs recent unlock message
Low Voltage Alarm	5.0V+(0.2V) (lock will remind you to change battery, that time can support atleast 100 times unlocking.)
Working Humidity	16%RH-93%RH
Dynamic Current	≤150mA

Leo is a hotel lock built with a high quality steel and mechanical key access.It uses RFID card technology for smooth, secure entry and guest convenience.Includes features like card loss reporting, low battery alerts, and high usage durability.Compatible with PMS systems and supports multifunctional card use.

Brizo

Stock Generally Available



Colors Available:



Silver



Gold

Door Thickness:

38-55mm

Mortise Measurement



8# Mortise

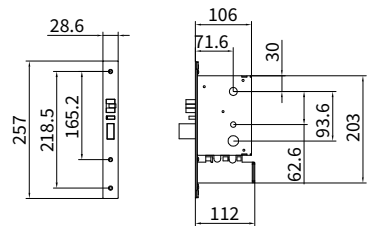

Unit: mm

Panel Measurement

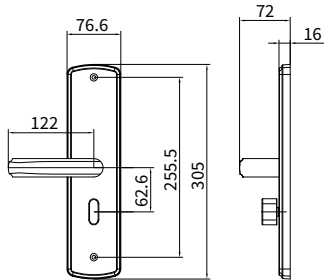
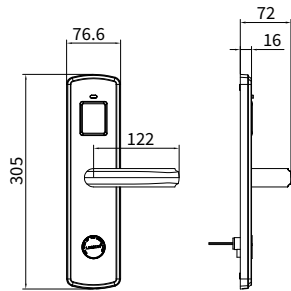

Unit: mm

→ Technical Parameter

Lock type	Mf card Hotel lock
Unlock way	Mifare S50 card (13.56MHZ) + Mechanical key
Material	Stainless steel both panels+ stainless steel mortise latch+ Alloy Key
Power Supply	4xAA Alkaline battery
Battery life	Around 10000 times (More than one year)
Mortise life	Around 200,000 times
Static Current	<40uA
Door thickness	38-60mm
Working Temp.	-20-55 C
Unlock Record	Record 800pcs recent unlock message
Low Voltage Alarm	5.0V+(0.2V) (lock will remind you to change battery, that time can support atleast 100 times unlocking.)
Working Humidity	16%RH-93%RH
Dynamic Current	≤150mA

Brizo is a modern lock system with a clean design and safety-first features.It supports card and key entry, passage function, and data tracking. Made with durable materials for long-term hotel use. Built with RFID and Works with PMS software for smooth front desk operations.

Jupiter

Stock Generally Available

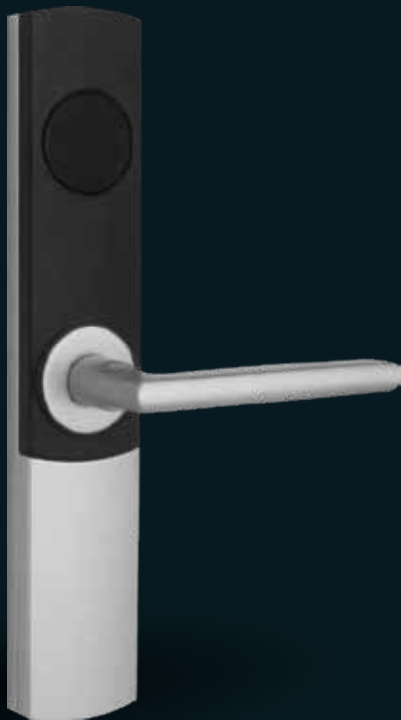

Colors Available:



Silver Gold Black

Door Thickness:

38-55mm

Mortise Measurement



8# Mortise

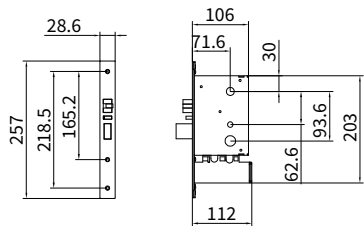

Unit: mm

Panel Measurement

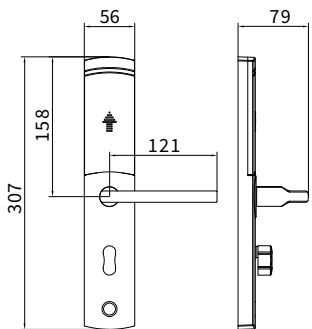
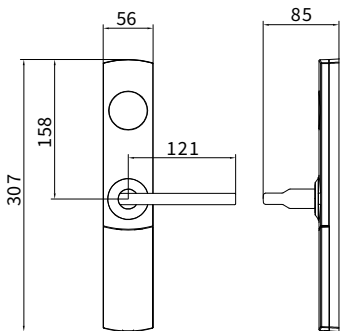

Unit: mm

→ Technical Parameter

Lock type	MF card Hotel lock
Unlock way	Mifare S50 card (13.56MHZ) + Mechanical key
Material	Zinc alloy both panels + stainless steel mortise latch + Alloy Key
Power Supply	4xAA Alkaline battery
Battery life	Around 10000 times (More than one year)
Mortise life	Around 200,000 times
Static Current	<40uA
Door thickness	38-60mm
Working Temp.	-20-55 C
Unlock Record	Record 800pcs recent unlock message
Low Voltage Alarm	5.0V+(0.2V) (lock will remind you to change battery, that time can support atleast 100 times unlocking.)
Working Humidity	16%RH-93%RH
Dynamic Current	≤150mA

Jupiter features zinc alloy panels and a stainless steel latch for extra strength. Supports RFID card access and stores 800 recent unlock records. Equipped with safety mortise and card management functions. Compatible with hotel management systems and energy savers.

Keres

Stock Generally Available



Colors Available:



Black

Door Thickness:

38-55mm

Mortise Measurement



8# Mortise

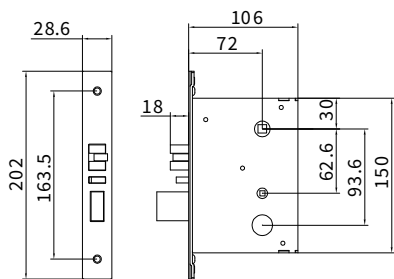

Unit: mm

Panel Measurement

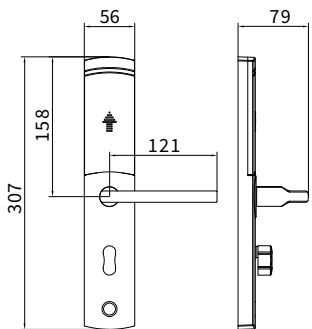
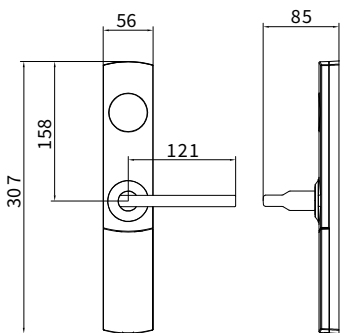

Unit: mm

→ Technical Parameter

Lock type	MF card Hotel lock
Unlock way	Mifare S50 card (13.56MHZ) + Mechanical key
Material	Stainless steel both panels+ stainless steel mortise latch+ Alloy Key
Power Supply	4xAA Alkaline battery
Battery life	Around 10000 times (More than one year)
Mortise life	Around 200,000 times
Static Current	<40uA
Door thickness	38-60mm
Working Temp.	-20-55 C
Unlock Record	Record 800pcs recent unlock message
Low Voltage Alarm	5.0V+(0.2V) (lock will remind you to change battery, that time can support atleast 100 times unlocking.)
Working Humidity	16%RH-93%RH
Dynamic Current	≤150mA

Keres provides stable hotel room access with superior steel construction.Uses Mifare cards and offers reliable card-key unlocking.Includes card reporting, passage mode, and long battery life.Built to integrate with standard hotel PMS systems.

C17

Stock Generally Available



Colors Available:



Black

Door Thickness:

38-55mm

Mortise Measurement



8# Mortise

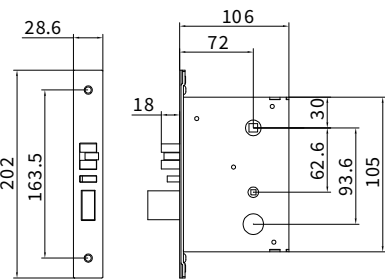

Unit: mm

Panel Measurement

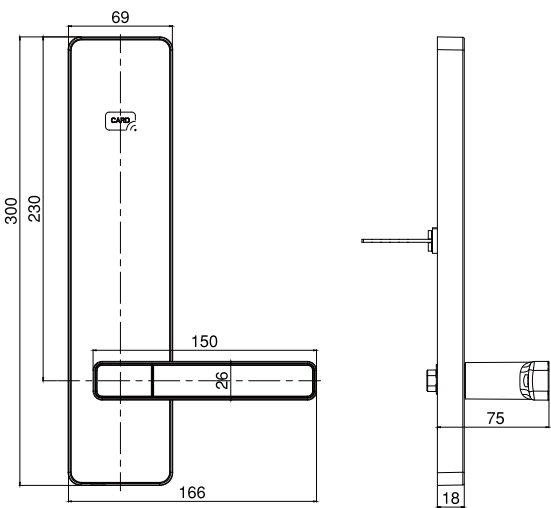

Unit: mm

→ Technical Parameter

Lock type	MF card Hotel lock
Unlock way	Mifare S50 card (13.56MHZ) + Mechanical key
Material	Zinc alloy both panels + stailless steel mortise latch + Alloy Key
Power Supply	4xAA Alkaline battery
Battery life	Around 10000 times (More than one year)
Mortise life	Around 200,000 times
Static Current	<40uA
Door thickness	38-60mm
Working Temp.	-20-55 C
Unlock Record	Record 800pcs recent unlock message
Low Voltage Alarm	5.0V+(0.2V) (lock will remind you to change battery, that time can support atleast 100 times unlocking.)
Working Humidity	16%RH-93%RH
Dynamic Current	≤150mA

C17 is built for simplicity and durability in hospitality environments. With RFID functionality and mechanical key backup, it's easy to manage. Zinc alloy body ensures long-lasting use and guest safety. Ideal for hotels looking for a straightforward locking system.

Archer

Stock Generally Available



Colors Available:



Black

Door Thickness:

38-55mm

Mortise Measurement



8# Mortise

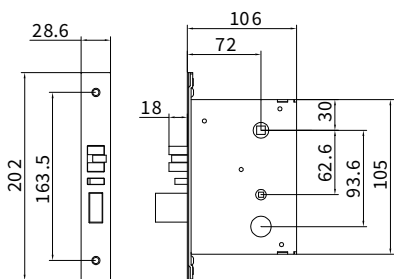

Unit: mm

Panel Measurement

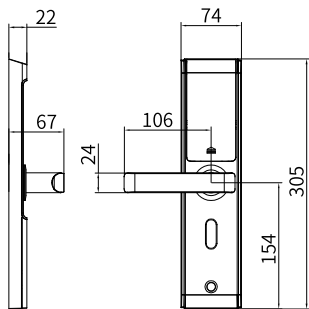
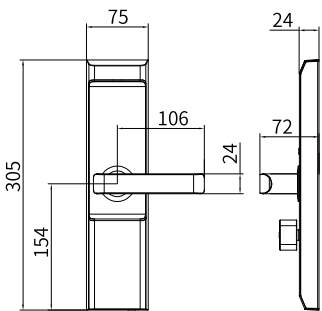

Unit: mm

→ Technical Parameter

Lock type	MF card Hotel lock
Unlock way	Mifare S50 card (13.56MHZ) + Mechanical key
Material	Aluminium both panels+ stailless steel mortise latch+ Alloy Key
Power Supply	4xAA Alkaline battery
Battery life	Around 10000 times (More than one year)
Mortise life	Around 200,000 times
Static Current	<40uA
Door thickness	38-60mm
Working Temp.	-20-55 C
Unlock Record	Record 800pcs recent unlock message
Low Voltage Alarm	5.0V+(0.2V) (lock will remind you to change battery, that time can support atleast 100 times unlocking.)
Working Humidity	16%RH-93%RH
Dynamic Current	≤150mA

Archer combines aluminum panel design with secure access. It's lightweight yet strong, and includes RFID card management tools.Suited for hotels that want a clean design and essential smart features.Supports integration with existing PMS platforms.

Athena

Stock Generally Available



Colors Available:



Silver

Door Thickness:

38-55mm

Mortise Measurement

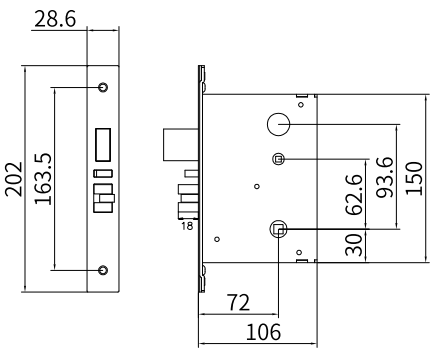

Unit: mm

Panel Measurement

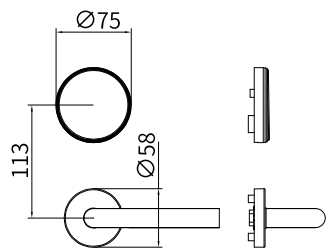
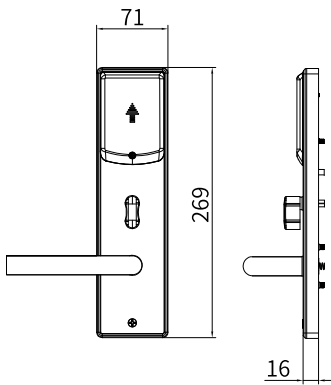

Unit: mm

→ Technical Parameter

Lock type	MF card Hotel lock
Unlock way	Mifare S50 card (13.56MHZ) + Mechanical key
Material	Stainless steel both panels+ stainless steel mortise latch+ Alloy Key
Power Supply	4xAA Alkaline battery
Battery life	Around 10000 times (More than one year)
Mortise life	Around 200,000 times
Static Current	<40uA
Door thickness	38-60mm
Working Temp.	-20-55 C
Unlock Record	Record 800pcs recent unlock message
Low Voltage Alarm	5.0V+(0.2V) (lock will remind you to change battery, that time can support atleast 100 times unlocking.)
Working Humidity	16%RH-93%RH
Dynamic Current	≤150mA

Athena is a stainless steel hotel lock built for everyday use.It includes unlock history tracking, low battery alerts, and card flexibility. Designed with RFID technology, it's easy for staff to manage and reliable for guest use.Works with standard hotel management systems.

Eros

Stock Generally Available



Colors Available:



Door Thickness:

38-55mm

Mortise Measurement

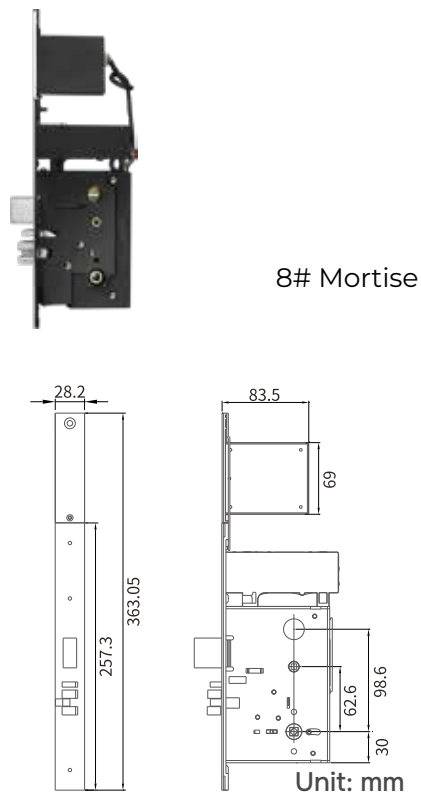

Panel Measurement

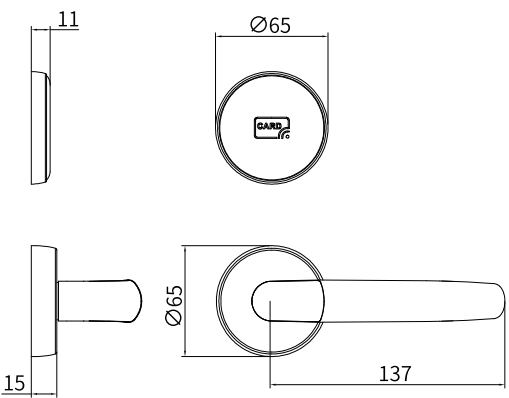

Unit: mm

→ Technical Parameter

Lock type	MF card Hotel lock
Unlock way	Mifare S50 card (13.56MHZ) + Mechanical key
Material	Stainless steel both panels+ stainless steel mortise latch+ Alloy Key
Power Supply	4xAA Alkaline battery
Battery life	Around 10000 times (More than one year)
Mortise life	Around 200,000 times
Static Current	<40uA
Door thickness	38-60mm
Working Temp.	-20-55 C
Unlock Record	Record 800pcs recent unlock message
Low Voltage Alarm	5.0V+(0.2V) (lock will remind you to change battery, that time can support atleast 100 times unlocking.)
Working Humidity	16%RH-93%RH
Dynamic Current	≤150mA

Eros is a practical locking solution for guest rooms and hotel areas.It features RFID-based access, mechanical key backup, energy-saving operation, and long battery life.Made from superior steel for lasting durability.Easily connects with PMS and access control systems.

Metis

Stock Generally Available



Colors Available:



Door Thickness:

38-55mm

Mortise Measurement

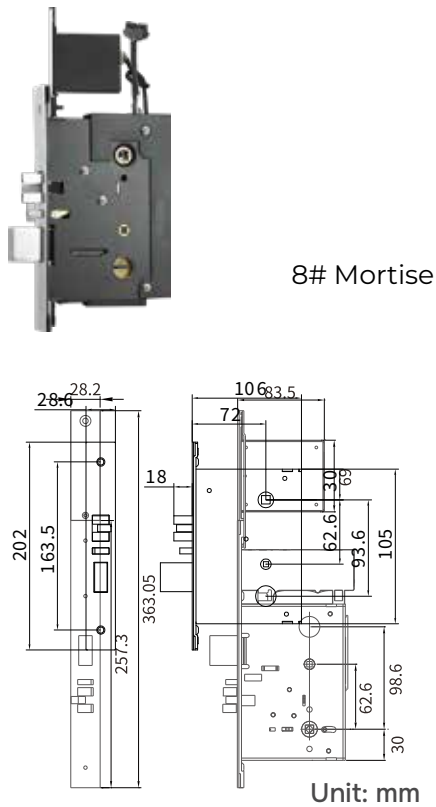

Panel Measurement

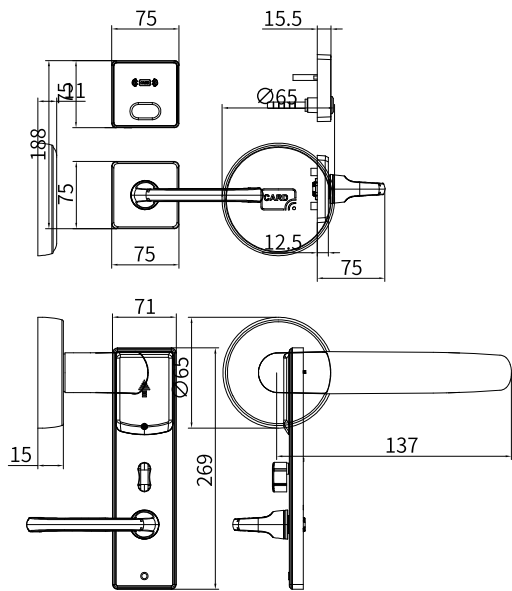

→ Technical Parameter

Lock type	MF card Hotel lock
Unlock way	Mifare S50 card (13.56MHZ) + Mechanical key
Material	Stainless steel both panels+ stainless steel mortise latch+ Alloy Key
Power Supply	4xAA Alkaline battery
Battery life	Around 10000 times (More than one year)
Mortise life	Around 200,000 times
Static Current	<40uA
Door thickness	38-60mm
Working Temp.	-20-55 C
Unlock Record	Record 800pcs recent unlock message
Low Voltage Alarm	5.0V+(0.2V) (lock will remind you to change battery, that time can support atleast 100 times unlocking.)
Working Humidity	16%RH-93%RH
Dynamic Current	≤150mA

Metis is a simple, stainless steel hotel lock with efficient access.It logs recent unlocks, supports mechanical override, and has passage mode.Featuring RFID it's a practical choice for hotels seeking reliable, low-maintenance locks.Easily integrates with front desk software systems.

Olympus

Stock Generally Available



Colors Available:



Silver Black

Door Thickness:

38-55mm

Mortise Measurement

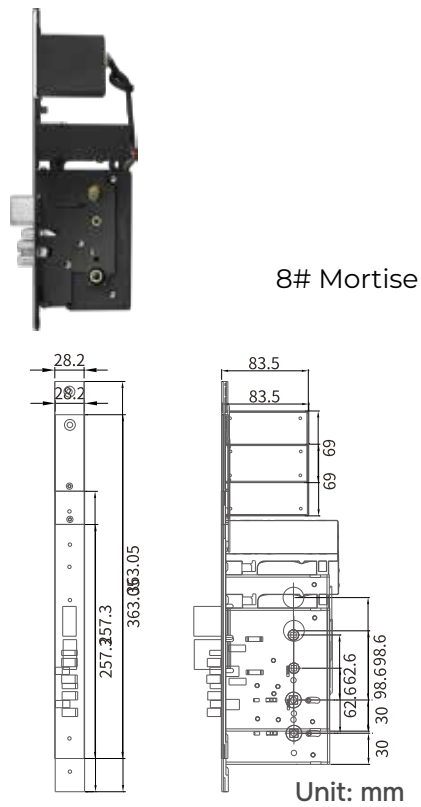

Panel Measurement

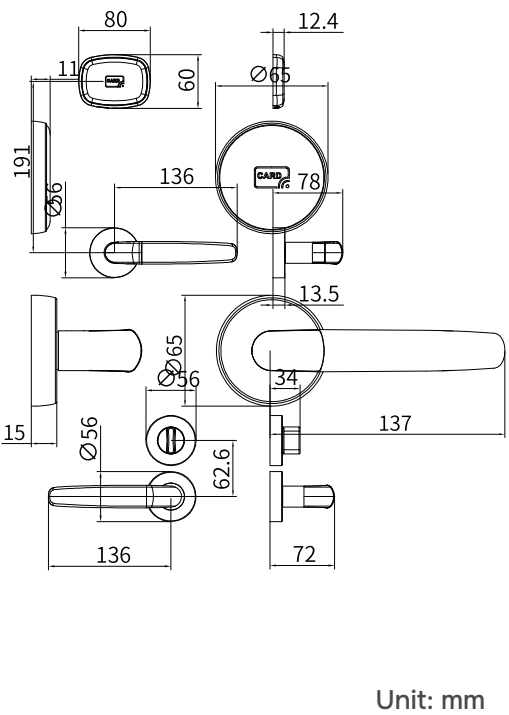

→ Technical Parameter

Lock type	MF card Hotel lock
Unlock way	Mifare S50 card (13.56MHZ) + Mechanical key
Material	Stainless steel both panels+ stainless steel mortise latch+ Alloy Key
Power Supply	4xAA Alkaline battery
Battery life	Around 10000 times (More than one year)
Mortise life	Around 200,000 times
Static Current	<40uA
Door thickness	38-60mm
Working Temp.	-20-55 C
Unlock Record	Record 800pcs recent unlock message
Low Voltage Alarm	5.0V+(0.2V) (lock will remind you to change battery, that time can support atleast 100 times unlocking.)
Working Humidity	16%RH-93%RH
Dynamic Current	≤150mA

Olympus is a robust hotel RFID lock with clean design and smart features.It supports multifunctional card access and card loss handling. Built with advanced RFID technology and durable materials to support daily hotel operations.Ideal for mid to large-sized hotels using PMS software.



Ceto



Apollo



Mars



Leo



Brizo

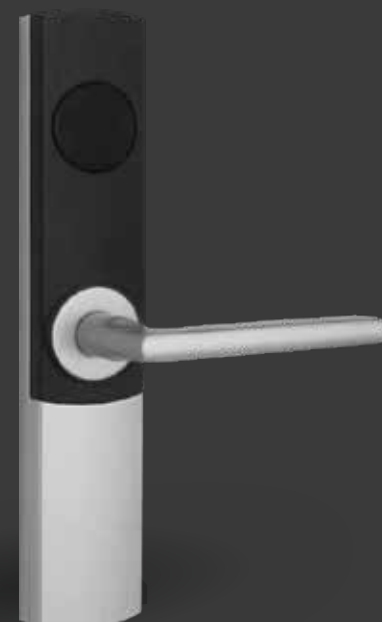

Jupiter



Keres



C17



Archer



Athena



Eros



Metis

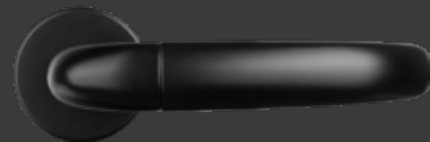

Olympus